

## Whitworth thread (with end)

External thread/ВНІШНЯЯ

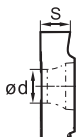

Y type

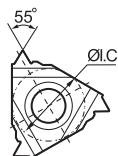

Z type

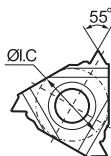

Type		Dimensions(mm)				Grade	
The right hand tools	The left hand tools	螺距 Pitch	S	ØI.C	ød	KLT115	
						R	L
YT16.01W-8W	ZT16.01W-8W	8	3.97	9.525	4.4	○	○
YT16.01W-9W	ZT16.01W-9W	9	3.97	9.525	4.4	○	○
YT16.01W-10W	ZT16.01W-10W	10	3.97	9.525	4.4	○	○
YT16.01W-11W	ZT16.01W-11W	11	3.97	9.525	4.4	○	○
YT16.01W-12W	ZT16.01W-12W	12	3.97	9.525	4.4	○	○
YT16.01W-14W	ZT16.01W-14W	14	3.97	9.525	4.4	○	○
YT16.01W-16W	ZT16.01W-16W	16	3.97	9.525	4.4	○	○

★ Recommended grade

● Available grade

○ Make-to-order

Internal thread/Внутренняя резьба



Y type

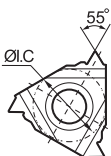

Z type



Type		Dimensions(mm)				Grade	
The right hand tools	The left hand tools	Pitch	S	ØI.C	ød	KLT115	
						R	L
YT16.01N-8W	ZT16.01N-8W	8	3.97	9.525	4.4	○	○
YT16.01N-9W	ZT16.01N-9W	9	3.97	9.525	4.4	○	○
YT16.01N-10W	ZT16.01N-10W	10	3.97	9.525	4.4	○	○
YT16.01N-11W	ZT16.01N-11W	11	3.97	9.525	4.4	○	○
YT16.01N-12W	ZT16.01N-12W	12	3.97	9.525	4.4	○	○
YT16.01N-14W	ZT16.01N-14W	14	3.97	9.525	4.4	○	○
YT16.01N-16W	ZT16.01N-16W	16	3.97	9.525	4.4	○	○

★ Recommended grade

● Available grade

○ Make-to-order