

DC

F1

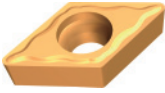

F2

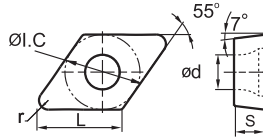

Type	Dimensions(mm)					Coated cemented carbide										Cermet		Cemented carbide							
	L	Øl.C	S	ød	r	KBC710	KBC715	KBC720	KBC725	KBC730	KBG130	KBG202	KBM710	KBD102	KBD120	KBD125	KBD130	KLТ530	KLТ530C	KLТ310	KLТ340	KLТ051	KLТ110	KLТ120	
DCMT070202-F1	7.8	6.35	2.38	2.8	0.2	●		●	○			○						○							
DCMT070204-F1	7.8	6.35	2.38	2.8	0.4	●	○	●	★	○		●	○	○				○						●	
DCMT070208-F1	7.8	6.35	2.38	2.8	0.8	○	○	○		○															
DCMT11T302-F1	11.6	9.525	3.97	4.4	0.2	●		●	○			●						○						○	
DCMT11T304-F1	11.6	9.525	3.97	4.4	0.4	●	★	●	★	○		●	●	○	●	○		●		○				○	
DCMT11T308-F1	11.6	9.525	3.97	4.4	0.8	●	★	●	○			○	○					○							
DCMT070204-F2	7.8	6.35	2.38	2.8	0.4	●	★	●	★	●	●		●		○	●									
DCMT070208-F2	7.8	6.35	2.38	2.8	0.8	●	★	●	★	○		○			○										
DCMT11T304-F2	11.6	9.525	3.97	4.4	0.4	●	★	●	★	○	●	●	●	○	●	○		●		○			●	○	
DCMT11T308-F2	11.6	9.525	3.97	4.4	0.8	●	★	●	★	●	●	○	●	●	○			○						○	
DCMT11T312-F2	11.6	9.525	3.97	4.4	1.2				○																

★ Recommended grade

● Available grade

○ Make-to-order

Applicable tool



ТОВ "Фрактальність"  
м. Київ  
вул. Машинобудівна, 46  
www.fractalnost.com.ua

тел. 044 227-57-73  
факс 044 379-15-33

## DC

### F3

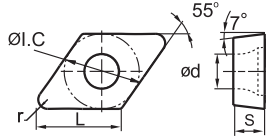

Type	Dimensions(mm)					Coated cemented carbide										Cemented carbide									
	L	ØI.C	S	ød	r	KBC710	KBC715	KBC720	KBC725	KBC730	KBG130	KBM710	KBM720	KBM253	KBD110	KBD102	KBD120	KBD125	KBD130	KLT310	KLT340	KLT051	KLT110	KLT120	
<b>DCMT11T304-F3</b>	11.6	9.525	3.97	4.4	0.4	○	●	○	○			○			○		●								
<b>DCMT11T308-F3</b>	11.6	9.525	3.97	4.4	0.8	●	●	★	○			○			○	●	●				○				
<b>DCMT11T312-F3</b>	11.6	9.525	3.97	4.4	1.2	○	●																		
<b>DCMW070204</b>	7.8	6.35	2.38	2.8	0.4										○										
<b>DCMW11T304</b>	11.6	9.525	3.97	4.4	0.4											●				○			●		
<b>DCMW11T308</b>	11.6	9.525	3.97	4.4	0.8											○				○		●			

★ Recommended grade

● Available grade

○ Make-to-order

### Applicable tool

