

CN□□

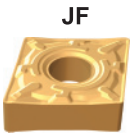

JF

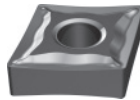

BF

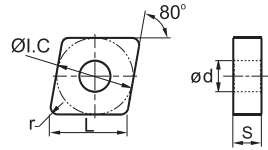

型号 Type	尺寸 Dimensions(mm)					涂层硬质合金 Coated cemented carbide														金陶 Cermet				
	L	Ø1.C	S	ød	r	KBC710	KBC715	KBC720	KBC725	KBC730	KBG130	KBG202	KBG131	KBG135	KBM710	KBM253	KBD110	KBD102	KBD120	KBD125	KBD130	KLТ530	KLТ530C	
CNMG090304-JF	9.7	9.525	3.18	3.81	0.4	○	○		○			○												
CNMG090308-JF	9.7	9.525	3.18	3.81	0.8	○	○	○	○															
CNMG120404-JF	12.9	12.7	4.76	5.16	0.4	●	★	●	★			○			○	○							○	
CNMG120408-JF	12.9	12.7	4.76	5.16	0.8	○	★	●	★	○		○			●	○								●
CNMG120412-JF	12.9	12.7	4.76	5.16	1.2	○	★	○	○							○								
CNMG090304-BF	9.7	9.525	3.18	3.81	0.4							●	★											
CNMG090308-BF	9.7	9.525	3.18	3.81	0.8							○	★											
CNMG120404-BF	12.9	12.7	4.76	5.16	0.4							●	★											
CNMG120408-BF	12.9	12.7	4.76	5.16	0.8					●		●	★											
CNMG120412-BF	12.9	12.7	4.76	5.16	1.2							○	★											

★主推牌号 Recommended grade ●可选牌号 Available grade ○按订单生产 Make-to-order



03680 м. Київ, Машинобудівна 46

тел.: +38 044 227-57-73

ф/авт.: +38 044 379-15-33

www.fractalnost.com.ua

■ 配套刀具 Applicable tool



CN□□

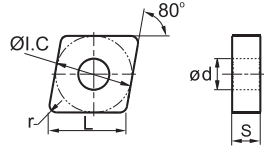

型号 Type	尺寸 Dimensions(mm)					涂层硬质合金 Coated cemented carbide														金陶 Cermet				
	L	ØI.C	S	ød	r	KBC710	KBC715	KBC720	KBC725	KBC730	KBG130	KBG202	KBG135	KBM710	KBM720	KBM253	KBD110	KBD102	KBD120	KBD125	KBD130	KL530	KL530C	
CNMG090304-M1	9.7	9.525	3.18	3.81	0.4	●	○	●	○															
CNMG090308-M1	9.7	9.525	3.18	3.81	0.8	○		●	○										○					
CNMG120404-M1	12.9	12.7	4.76	5.16	0.4	●	○	●	★	○								★		★	○			
CNMG120408-M1	12.9	12.7	4.76	5.16	0.8	●	★	●	★	●								★	●	★	★			
CNMG120412-M1	12.9	12.7	4.76	5.16	1.2	○	○	●	★	●								★	●	★	★			
CNMG120416-M1	12.9	12.7	4.76	5.16	1.6	●	○	●	○	●								★		○				
CNMG160608-M1	16.1	15.875	6.35	6.35	0.8	●		●	○	○								○	●	○				
CNMG160612-M1	16.1	15.875	6.35	6.35	1.2	●		●	○	●								★	●	○				
CNMG160616-M1	16.1	15.875	6.35	6.35	1.6			●	○									○	○	○				
CNMG190608-M1	19.3	19.05	6.35	7.94	0.8	●		●	○	○										●				
CNMG190612-M1	19.3	19.05	6.35	7.94	1.2	●		●	★	●								○	●	★				
CNMG190616-M1	19.3	19.05	6.35	7.94	1.6	●		●	○	●								○						

★主推牌号 Recommended grade ●可选牌号 Available grade ○按订单生产 Make-to-order



03680 м. Київ, Машинобудівна 46
 тел.: +38 044 227-57-73
 ф/авт.: +38 044 379-15-33
www.fractalnost.com.ua

■ 配套刀具 Applicable tool



CN□□

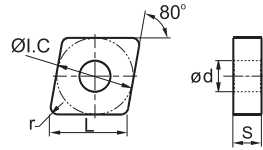
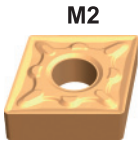

型号 Type	尺寸 Dimensions(mm)					涂层硬质合金 Coated cemented carbide												金陶 Cermet						
	L	Ø1.C	S	ød	r	KBC710	KBC715	KBC720	KBC725	KBC730	KBG130	KBG202	KBG135	KBM710	KBM720	KBM253	KBD110	KBD102	KBD120	KBD125	KBD130	KLТ530	KLТ530C	
CNMG090304-M2	9.7	9.525	3.18	3.81	0.4	○	○	●	○						●									
CNMG090308-M2	9.7	9.525	3.18	3.81	0.8			○	○						●									
CNMG120404-M2	12.9	12.7	4.76	5.16	0.4	●	★	●	★	○	●	○		●								●		
CNMG120408-M2	12.9	12.7	4.76	5.16	0.8	●	★	●	★	●	●	○		●								●		
CNMG120412-M2	12.9	12.7	4.76	5.16	1.2	○	★	●	★	●	○			●										
CNMG120416-M2	12.9	12.7	4.76	5.16	1.6			●	○	●				○										
CNMG160608-M2	16.1	15.875	6.35	6.35	0.8	●	★	●	★	○				●										
CNMG160612-M2	16.1	15.875	6.35	6.35	1.2	○	○	●	★	○				○										
CNMG160616-M2	16.1	15.875	6.35	6.35	1.6	○	★	●	○	●				○										
CNMG190608-M2	19.3	19.05	6.35	7.94	0.8		○	●	○					○										
CNMG190612-M2	19.3	19.05	6.35	7.94	1.2	○	★	●	★	○				○										
CNMG190616-M2	19.3	19.05	6.35	7.94	1.6			●	★	○				○										

★主推牌号 Recommended grade ●可选牌号 Available grade ○按订单生产 Make-to-order



03680 м. Київ, Машинобудівна 46
 тел.: +38 044 227-57-73
 ф/авт.: +38 044 379-15-33
www.fractalnost.com.ua

配套刀具 Applicable tool



CN□□

CR

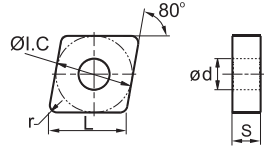

型号 Type	尺寸 Dimensions(mm)					涂层硬质合金 Coated cemented carbide														金陶 Cermet				
	L	Ø1.C	S	ød	r	KBC710	KBC715	KBC720	KBC725	KBC730	KBG130	KBG202	KBG135	KBM710	KBM720	KBM253	KBD110	KBD102	KBD120	KBD125	KBD130	KLТ530	KLТ530C	
CNMG120408-CR	12.9	12.7	4.76	5.16	0.8	●	★	●	★	●						●		●						
CNMG120412-CR	12.9	12.7	4.76	5.16	1.2	○	○	●	★	○						●		●						
CNMG120416-CR	12.9	12.7	4.76	5.16	1.6	○			○							●		●						
CNMG160608-CR	16.1	15.875	6.35	6.35	0.8			○	○							○								
CNMG160612-CR	16.1	15.875	6.35	6.35	1.2			●	★	○						●		○						
CNMG160616-CR	16.1	15.875	6.35	6.35	1.6			○	★	●														
CNMG190608-CR	19.3	15.875	6.35	7.94	0.8			○	○							●		○						
CNMG190612-CR	19.3	19.05	6.35	7.94	1.2	●	○	●	★	●						○		○						
CNMG190616-CR	19.3	19.05	6.35	7.94	1.6	○	○	●	★	●								○						
CNMG190624-CR	19.3	19.05	6.35	7.94	2.4	○		●	○	●														

★主推牌号 Recommended grade ●可选牌号 Available grade ○按订单生产 Make-to-order



03680 м. Київ, Машинобудівна 46

тел.: +38 044 227-57-73

ф/авт.: +38 044 379-15-33

www.fractalnost.com.ua

配套刀具 Applicable tool



CN□□

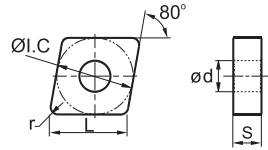
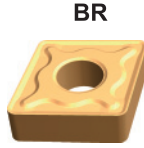

型号 Type	尺寸 Dimensions(mm)					涂层硬质合金 Coated cemented carbide													金陶 Cermet					
	L	ØI.C	S	ød	r	KBC710	KBC715	KBC720	KBC725	KBC730	KBG130	KBG202	KBG135	KBM710	KBM720	KBM253	KBD110	KBD102	KBD120	KBD125	KBD130	KLТ530	KLТ530C	
CNMM120412-CR	12.9	12.7	4.76	5.16	1.2			●	○															
CNMM160612-CR	16.1	15.875	6.35	6.35	1.2			●	○															
CNMM160616-CR	16.1	15.875	6.35	6.35	1.6				○															
CNMM190612-CR	19.3	19.05	6.35	7.94	1.2			●	○	●														
CNMM190616-CR	19.3	19.05	6.35	7.94	1.6			●	★	●														
CNMM190624-CR	19.3	19.05	6.35	7.94	2.4	○		○	○															
CNMM250924-CR	25.79	25.4	9.525	9.12	2.4			○	★	○														
CNMG120408-BR	12.9	12.7	4.76	5.16	0.8									●	★									
CNMG120412-BR	12.9	12.7	4.76	5.16	1.2									●	★									
CNMG160612-BR	16.1	15.875	6.35	6.35	1.2									●	★									
CNMG160616-BR	16.1	15.875	6.35	6.35	1.6									●	★									
CNMG190612-BR	19.3	19.05	6.35	7.94	1.2									●	★									
CNMG190616-BR	19.3	19.05	6.35	7.94	1.6									●	★									

★主推牌号 Recommended grade ●可选牌号 Available grade ○按订单生产 Make-to-order



03680 м. Київ, Машинобудівна 46

тел.: +38 044 227-57-73

ф/авт.: +38 044 379-15-33

www.fractalnost.com.ua

配套刀具 Applicable tool



CN□□

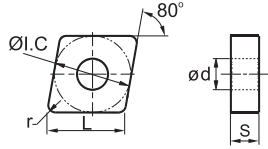

型号 Type	尺寸 Dimensions(mm)					涂层硬质合金 Coated cemented carbide										硬质合金 Cemented carbide								
	L	ØI.C	S	ød	r	KBC710	KBC715	KBC720	KBC725	KBC730	KBG135	KBM710	KBM720	KBM253	KBD110	KBD102	KBD120	KBD125	KBD130	KLТ310	KLТ340	KLТ051	KLТ110	KLТ120
CNMA120404	12.9	12.7	4.76	5.16	0.4										★	○	○	○						
CNMA120408	12.9	12.7	4.76	5.16	0.8										★	★	●	★						
CNMA120412	12.9	12.7	4.76	5.16	1.2										★	★	●	★						
CNMA120416	12.9	12.7	4.76	5.16	1.6										★	★		○						
CNMA160608	16.1	15.875	6.35	6.35	0.8											○	○	○						
CNMA160612	16.1	15.875	6.35	6.35	1.2											★	○							
CNMA160616	16.1	15.875	6.35	6.35	1.6										○	★		○						
CNMA160620	16.1	15.875	6.35	6.35	2.0												●							
CNMA160630	16.1	15.875	6.35	6.35	3.0												○							
CNMA190612	19.3	19.05	6.35	7.94	1.2										★	○		★						
CNMA190616	19.3	19.05	6.35	7.94	1.6										○	★		★						
CNMG120404	12.9	12.7	4.76	5.16	0.4	●		●				●			○	●						○		
CNMG120408	12.9	12.7	4.76	5.16	0.8	●	★	●	★	○		●			★	●	★	★	●		○			
CNMG120412	12.9	12.7	4.76	5.16	1.2	●	★	●	★					○	○		○							
CNMG160608	16.1	15.875	6.35	6.35	0.8	●		●				○				○				○		○		
CNMG160612	16.1	15.875	6.35	6.35	1.2			●		○							○							
CNMG160616	16.1	15.875	6.35	6.35	1.6			○																
CNMG190608	19.3	19.05	6.35	7.94	0.8	○		○		○														
CNMG190612	19.3	19.05	6.35	7.94	1.2	○		●		○							○							
CNMG190616	19.3	19.05	6.35	7.94	1.6	○		○		○							○							

★主推牌号 Recommended grade ●可选牌号 Available grade ○按订单生产 Make-to-order



CN□□

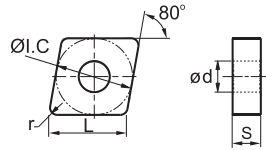

型号 Type	尺寸 Dimensions(mm)					涂层硬质合金 Coated cemented carbide										硬质合金 Cemented carbide								
	L	ØI.C	S	ød	r	KBC710	KBC715	KBC720	KBC725	KBC730	KBG130	KBG202	KBG135	KBM710	KBM720	KBM253	KBD110	KBD102	KLT310	KLT340	KLT051	KLT110	KLT120	
CNMM120404	12.9	12.7	4.76	5.16	0.4	○																		
CNMM120408	12.9	12.7	4.76	5.16	0.8	○		○																
CNMM120412	12.9	12.7	4.76	5.16	1.2	○													○	○				
CNMM190608	19.3	19.05	6.35	7.94	0.8					○									○					
CNMM190612	19.3	19.05	6.35	7.94	1.2			○	○															
CNMM190616	19.3	19.05	6.35	7.94	1.6			○																
CNMM190624	19.3	19.05	6.35	7.94	2.4					○														

★主推牌号 Recommended grade ●可选牌号 Available grade ○按订单生产 Make-to-order



03680 м. Київ, Машинобудівна 46
 тел.: +38 044 227-57-73
 ф/авт.: +38 044 379-15-33
www.fractalnost.com.ua

配套刀具 Applicable tool

