

**ER Spring Collet Chuck**
**Features:**

- The most popular collet chucks, one chuck can be used for end mills, drills, reamers and taps.
- Thread of the spring collet chuck and internal taper are precise ground.
- Supplied with standard clamp nut, backup screw is optional.
- Pre-balanced G6.3 / 8000 r.p.m. (standard grade)
- Higher pre-balanced grade are on request, additional charge is needed.

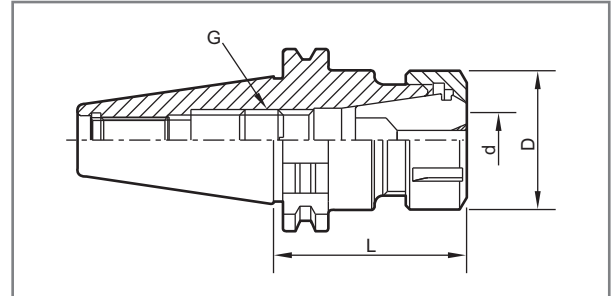

Taper Shank	Ordering Code	Type of Holder	L	D	d	G
SK40	342100-302	SK40-ER16-70	70	28	0.5-10	M10x1.5
	-304	-ER16-100	100			
	-402	-ER20-100	100	34	1-13	M12x1.75
	-502	-ER25-100	100	42	1-16	M16x2.0
	-602	-ER32-100	100	50	2-20	
	-702	-ER40-100	100	63	3-26	
SK50	352100-302	SK50-ER16-100	100	28	0.5-10	M10x1.5
	-402	-ER20-100	100	34	1-13	M12x1.75
	-502	-ER25-100	100	42	1-16	M12x1.75
	-602	-ER32-100	100	50	2-20	M16x2.0
	-702	-ER40-100	100	63	3-26	

**KCH Spring Collet Chuck**
**Features:**

- Supplied with a spanner.
- Please refer to page 43 for KCH collets.

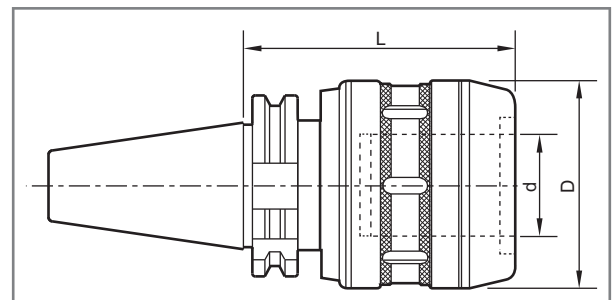

Taper Shank	Ordering Code	Type of holder	Clamping Range	L	D	d	Collet
SK40	342150-202	SK40-KCH20-80	Ø6-Ø20	80	54	20	C20
	342150-402	-KCH32-105	Ø6-Ø32	105		32	C32
SK50	352150-401	SK50-KCH32-100	Ø6-Ø32	100		32	C32
	352150-602	-KCH42-105	Ø6-Ø42	105		40	C42